

# STAINLESS STEEL

- 12 gauge stainless steel type 304 non magnetic with #4 finish
- Stainless steel hinge with staked pin
- Vandal & weather resistant enclosure NEMA 3R rainproof enclosure as listed by Underwriters Laboratories, Inc.
- Pry resistant 1" flanged doors
- Front door louvers with rain/bug guard
- Neoprene weather striping (full door)
- 3/4" plywood backboard (standard) stainless steel backboard (optional) mounted with 4 stainless steel bolts/wingnuts
- Internal document tray on door
- Mounting base included
- Limited warranty 15 years
- UL option adds circular lock handle in place of lock cover

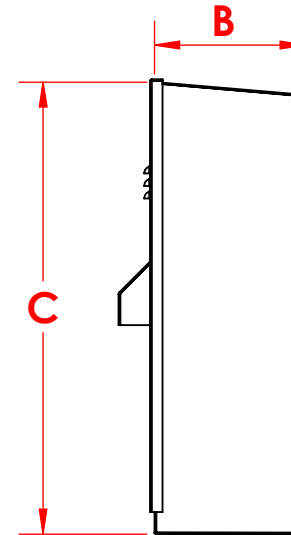
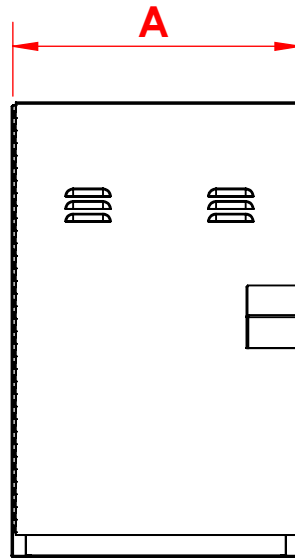
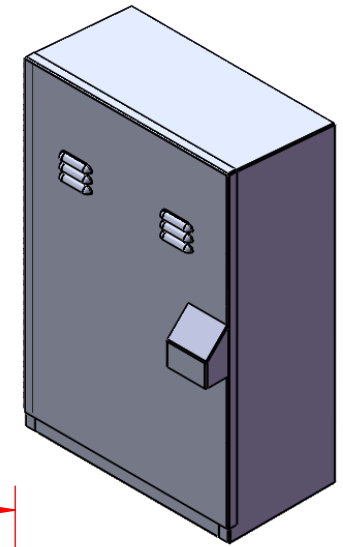
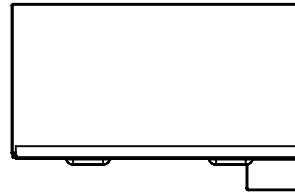

PART #	A	B	C
AS-18-SS	18"	12"	36"
AS-23-SS	23"	12"	36"
AS-2317-SS	23"	17"	36"
AS-35-SS	35"	12"	36"
AS-25-SS	25"	13"	41"

UNLESS OTHERWISE SPECIFIED:

**ALL DIMENSIONS OUTSIDE**  
 DIMENSIONS ARE IN INCHES  
 TOLERANCES:  
 FRACTIONAL ± .060  
 ANGULAR: BEND ± 1/2 DEGREE  
 TWO PLACE DECIMAL ± .030  
 THREE PLACE DECIMAL ± .010  
 INSIDE RADII: .031  
 MAX BURR: .010

MATERIAL

FINISH

DO NOT SCALE DRAWING

	NAME	DATE
DRAWN	K.MILLER	12/11/2018
CHECKED		
ENG APPR.		
MFG APPR.		
Q.A.		

COMMENTS:



**ALLSPEC ENCLOSURES, INC.**

582 South Grand Avenue  
 San Jacinto, Ca. 92582  
 Ph: 951-654-5500  
 Fax: 951-654-5150

TITLE:

**AS-SS SERIES**

DWG. NO.

**AS-SS SPEC SHEET**

REV

SHEET 1 OF 1

**PROPRIETARY AND CONFIDENTIAL**

THE INFORMATION CONTAINED IN THIS DRAWING IS THE SOLE PROPERTY OF ALL-SPEC ENCLOSURES, INC. ANY REPRODUCTION IN PART OR AS A WHOLE WITHOUT THE WRITTEN PERMISSION OF ALL-SPEC ENCLOSURES, INC. IS PROHIBITED.