

MILD STEEL

- 3/16" Mild Steel
- steel hinge with staked pin
- Vandal & weather resistant enclosure NEMA 3R rainproof enclosure as listed by Underwriters Laboratories, Inc.
- Pry resistant 1" flanged doors
- Front door louvers with rain/bug guard
- Neoprene weather striping (full door)
- 3/4" plywood backboard (standard) mounted with 4 bolts/wingnuts
- Internal document tray on door
- Powder coated (1 YEAR)
- Limited warranty (5 YEARS)

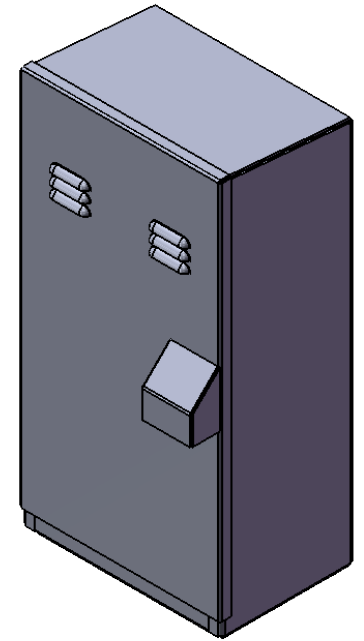
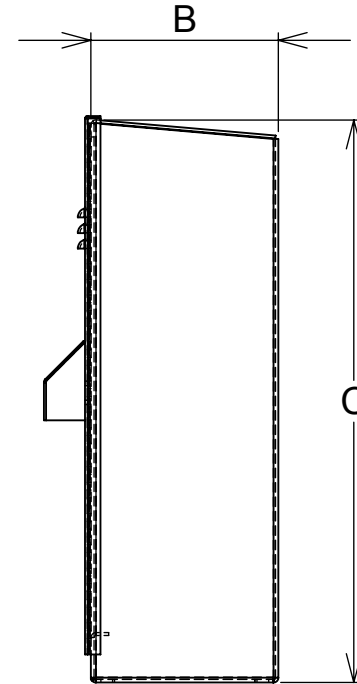
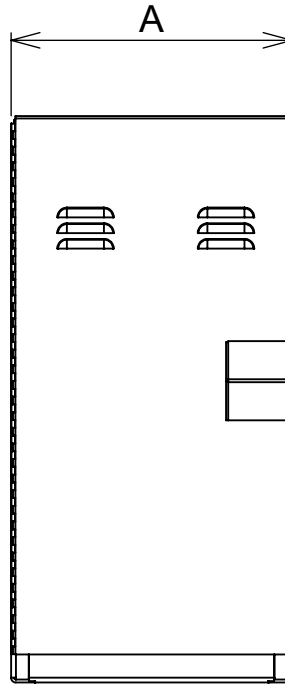

| PART # | A | B | C |
|---------|-----|-----|-----|
| AS-18 | 18" | 12" | 36" |
| AS-23 | 23" | 12" | 36" |
| AS-2317 | 23" | 17" | 36" |
| AS-35 | 35" | 12" | 36" |
| AS-25 | 25" | 13" | 41" |

UNLESS OTHERWISE SPECIFIED:

ALL DIMENSIONS OUTSIDE
 DIMENSIONS ARE IN INCHES
 TOLERANCES:
 FRACTIONAL ± .060
 ANGULAR: BEND ± 1/2 DEGREE
 TWO PLACE DECIMAL ± .030
 THREE PLACE DECIMAL ± .010
 INSIDE RADII: .031
 MAX BURR: .010

MATERIAL

FINISH

DO NOT SCALE DRAWING

| | NAME | DATE |
|-----------|-----------|----------|
| DRAWN | K. MILLER | 3/8/2017 |
| CHECKED | | |
| ENG APPR. | | |
| MFG APPR. | | |
| Q.A. | | |

COMMENTS:



ALLSPEC ENCLOSURES, INC.

582 South Grand Avenue
 San Jacinto, Ca. 92582
 Ph: 951-654-5500
 Fx: 951-654-5150

TITLE:

AS-SERIES SPEC SHEET

DWG. NO.

AS-0000 A

REV

SHEET 1 OF 1

PROPRIETARY AND CONFIDENTIAL
 THE INFORMATION CONTAINED IN THIS DRAWING IS THE SOLE PROPERTY OF ALL-SPEC ENCLOSURES, INC. ANY REPRODUCTION IN PART OR AS A WHOLE WITHOUT THE WRITTEN PERMISSION OF ALL-SPEC ENCLOSURES, INC. IS PROHIBITED.