

- 16 GA MILD STEEL
- POWDER COAT OFF-WHITE (RAL 9001)
- ACCOMODATES WHOLE-HOUSE OR MANOR SYSTEMS WITH USE OF WASHERS
- RECOMMEND MOUNTING TO 1X4 AS SHOWN, OR UNI-STRUT, TO KEEP OFF WALL

REV A - 8/2/22 - ADDED EXTRA MOUNTING HOLES TO FIT MULTIPLE BRACKETS, AND MADE COVER 3" TALLER TO FIT

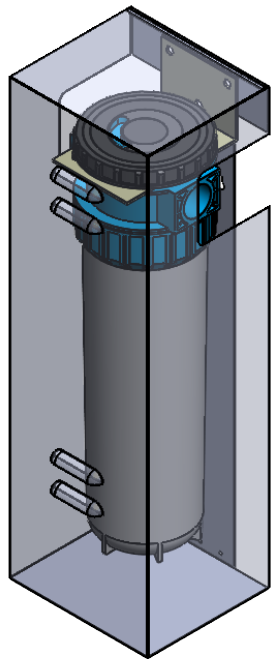
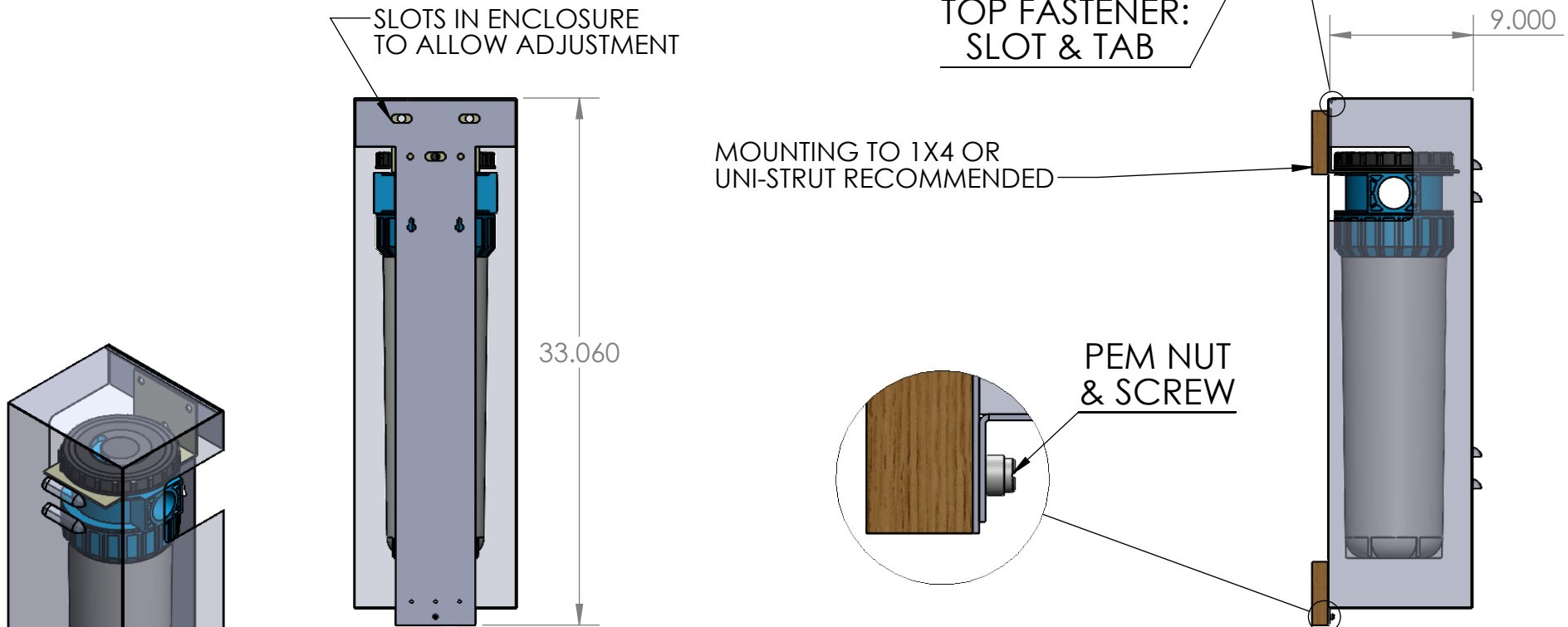

PROPRIETARY AND CONFIDENTIAL
 THE INFORMATION CONTAINED IN THIS DRAWING IS THE SOLE PROPERTY OF ALL-SPEC ENCLOSURES, INC. ANY REPRODUCTION IN PART OR AS A WHOLE WITHOUT THE WRITTEN PERMISSION OF ALL-SPEC ENCLOSURES, INC. IS PROHIBITED.

UNLESS OTHERWISE SPECIFIED:		NAME	DATE
ALL DIMENSIONS OUTSIDE DIMENSIONS ARE IN INCHES		DRAWN	K. MILLER 10/24/16
TOLERANCES:		CHECKED	
FRACTIONAL ± .060		ENG APPR.	
ANGULAR: BEND ± 1/2 DEGREE		MFG APPR.	
TWO PLACE DECIMAL ± .030		Q.A.	
THREE PLACE DECIMAL ± .010		COMMENTS:	
INSIDE RADII: .031		INSIDE RADIUS :	N/A
MAX BURR: .010		BEND DEDUCTION :	N/A
MATERIAL	16 GA (.063) CRS		
FINISH	POWDER COAT		
DO NOT SCALE DRAWING			

		ALLSPEC ENCLOSURES, INC. 582 South Grand Avenue San Jacinto, Ca. 92582 Ph: 951-654-5500 Fx: 951-654-5150	
TITLE: NUVO H2O FILTER ENCLOSURE			
DWG. NO. NUVO H2O-0000		REV	
			SHEET 1 OF 1